

iMPAKT

4 Inch SEG Fabric Frame Assembly and Installation Instructions

01 Component List

	DESCRIPTION
A	Extrusion - 4 Inch SEG Fabric Lightbox
B	Corner connector - 4 Inch SEG
C*	Straight connector - 4 Inch SEG
D*	Bracket - Wall mount - 4 Inch SEG
E*	Fastener - Eye bolt 1/4-20 4061
F	3 mm ACM backer panel (Optional)

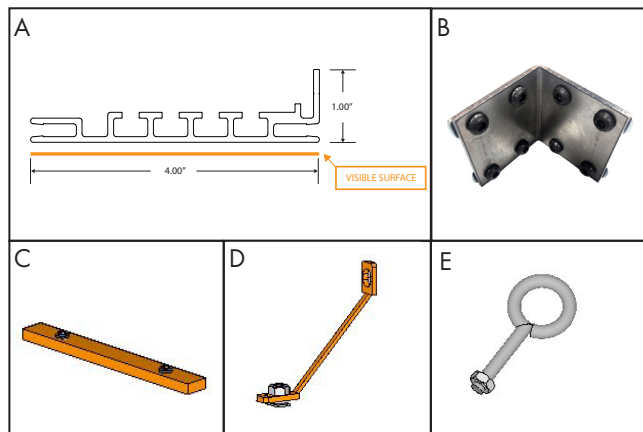

- *C - Straight connectors are provided only when extrusions are cut down for shipping
- *D - Brackets will be installed if product shipped assembled
- *E - Eye bolts are provided only for suspended frames

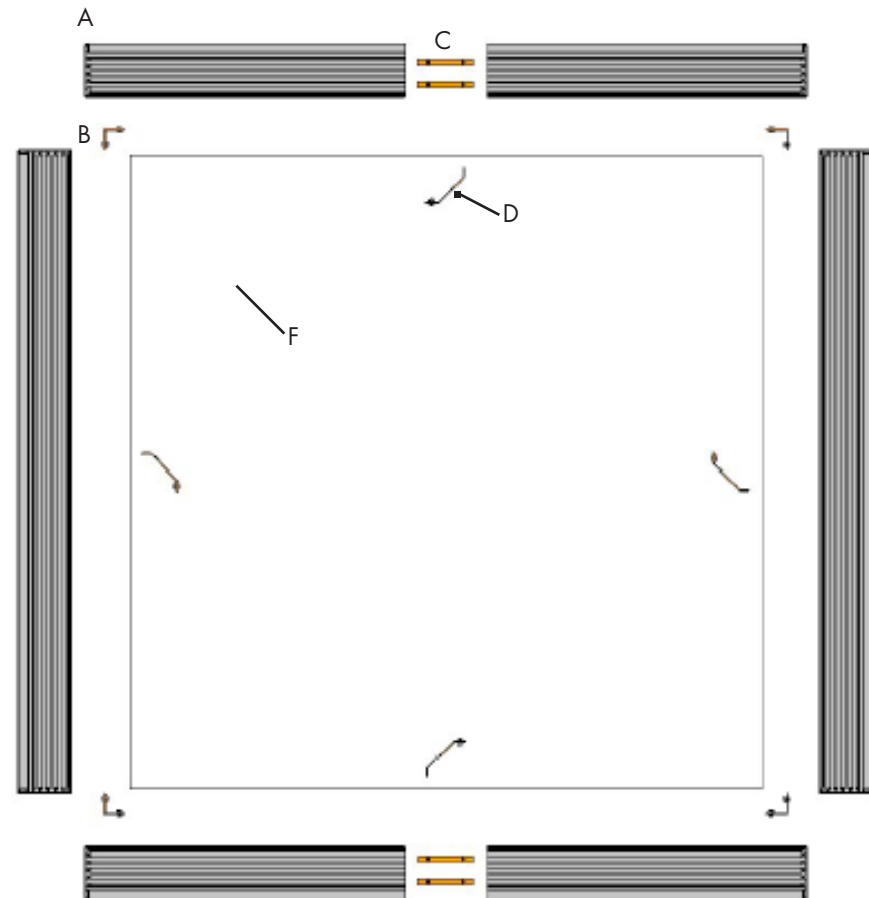

02 Wall Mount Brackets

iMPAKT

OPTION 1

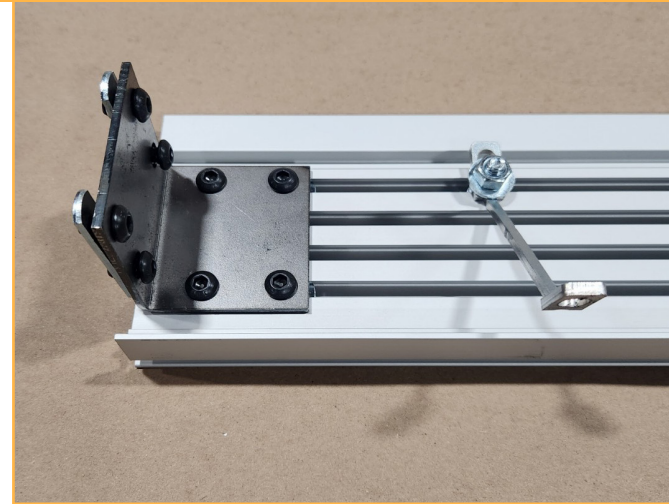
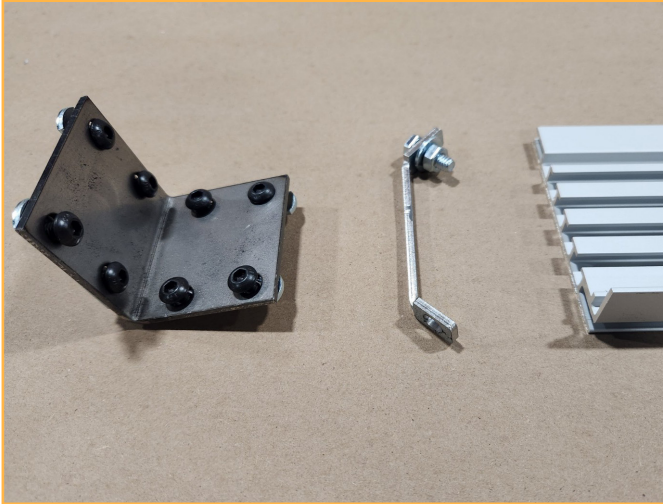

OPTION 2

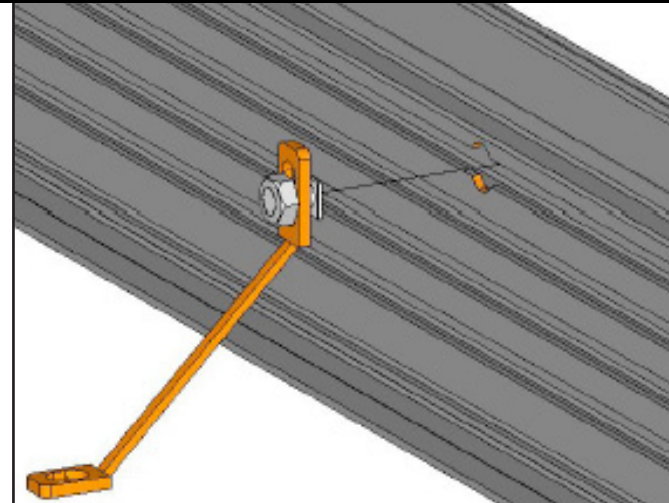
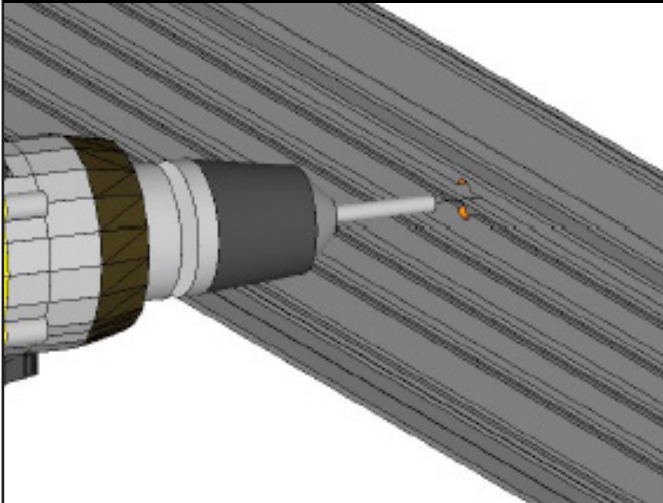

03 Corner Connectors

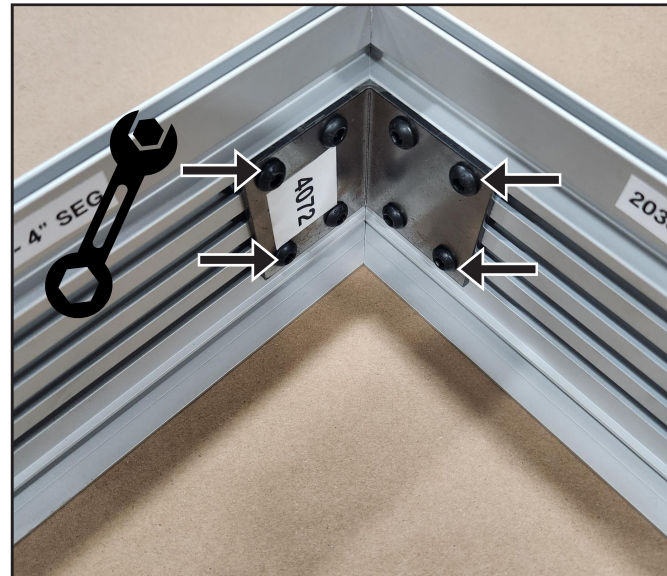
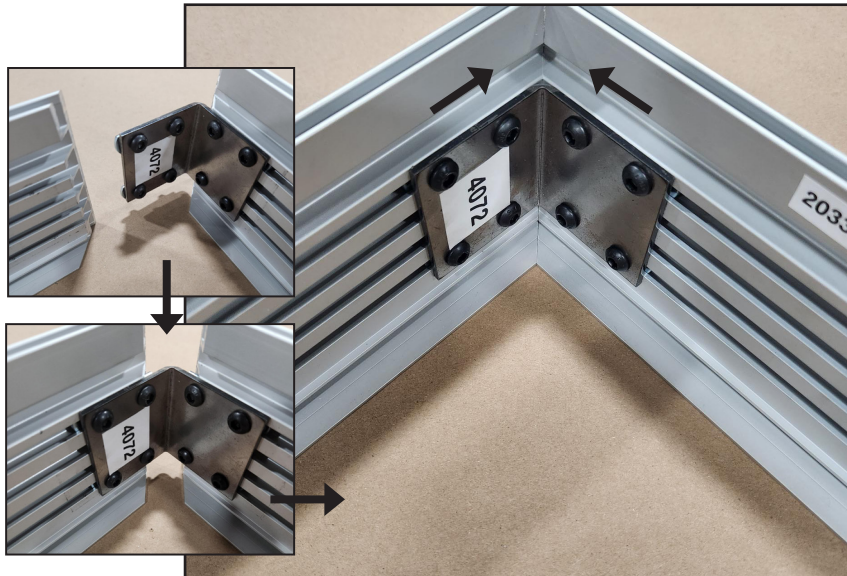
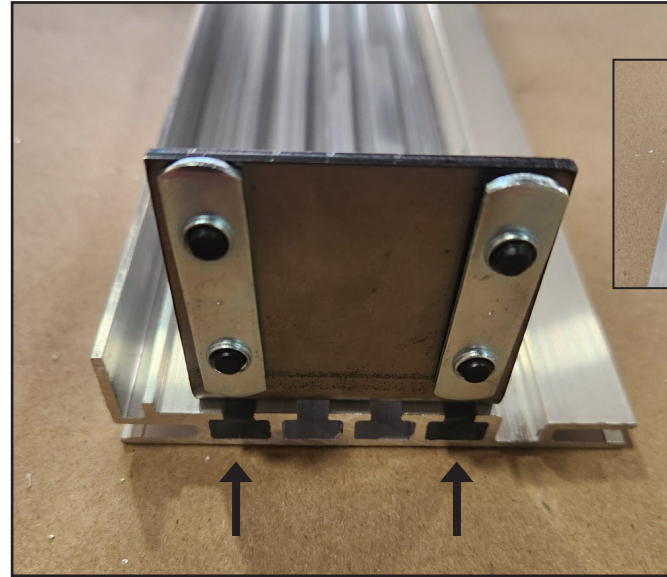
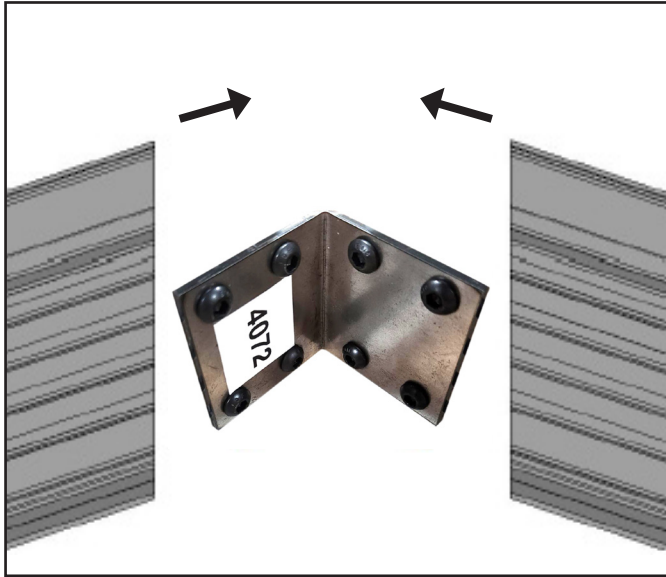

04 Straight Connectors

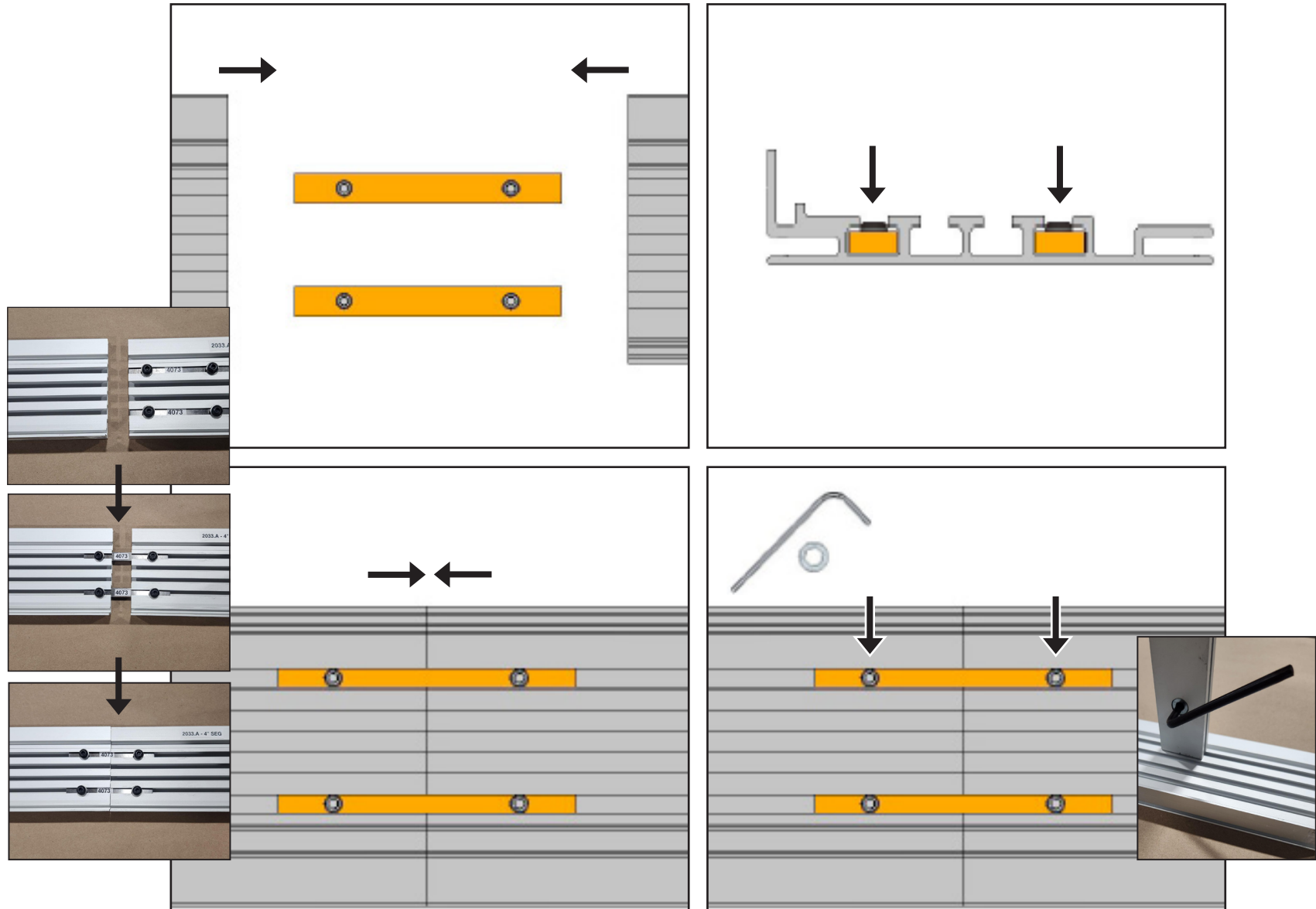

05 ACM Backer (Optional)

iMPAKT

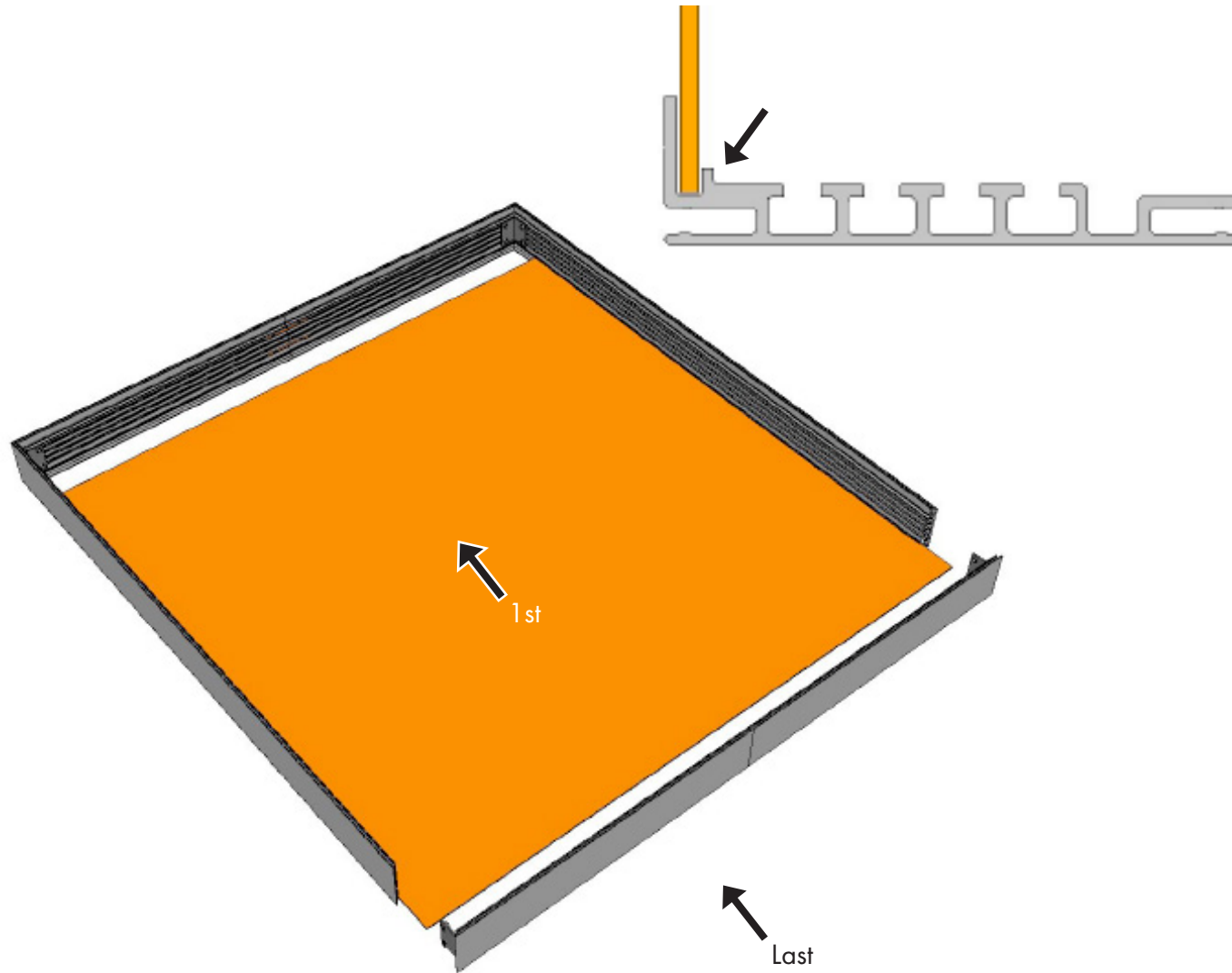

06 Mounting on a Wall

iMPAKT

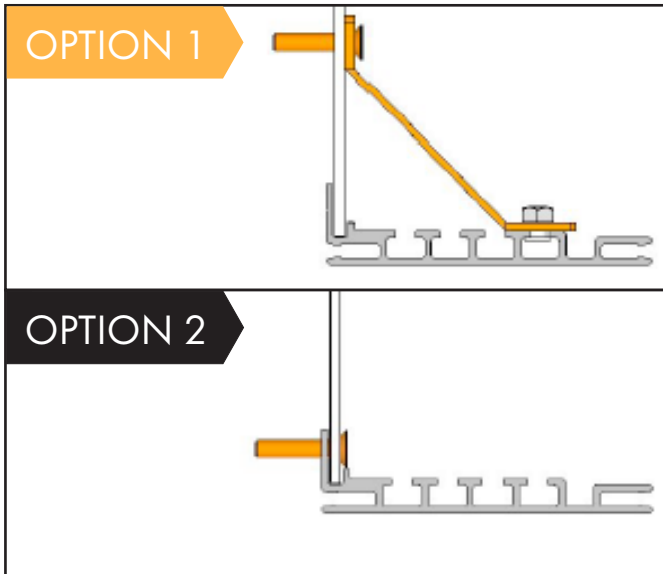
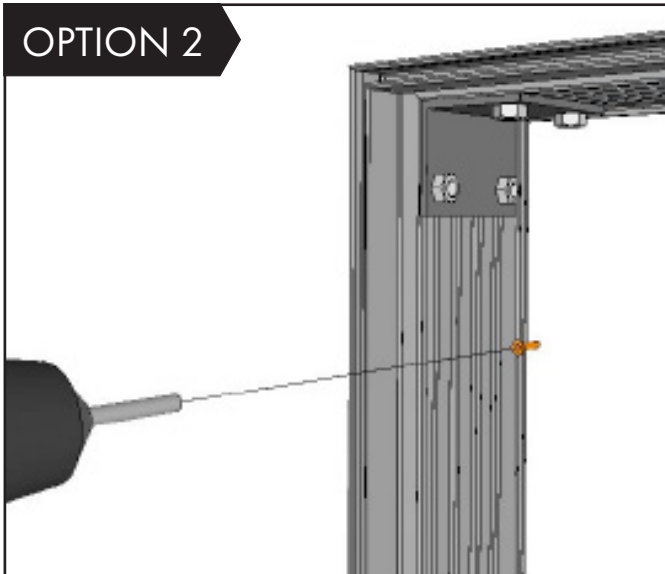
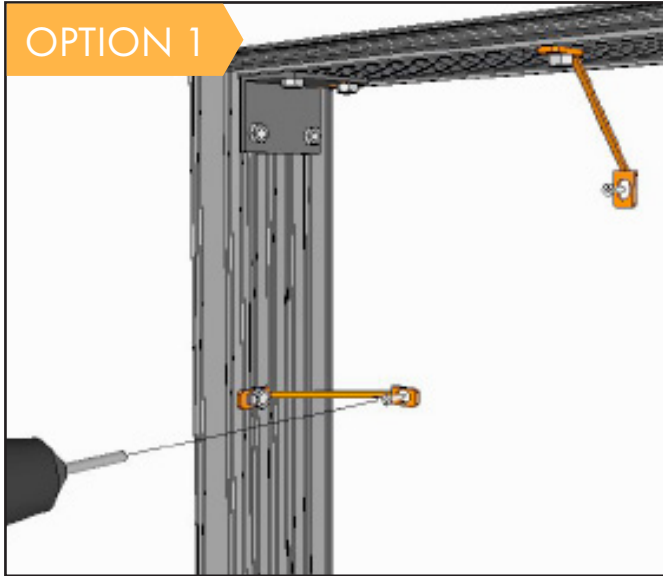
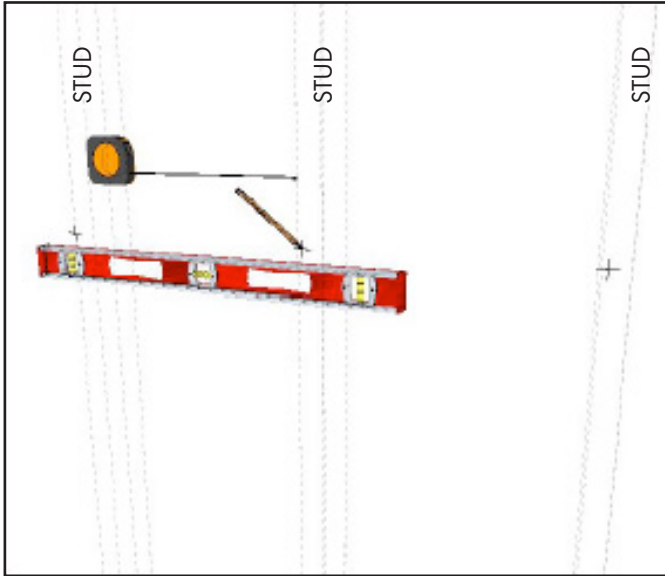

INSTALL SEG FABRIC

iMPAKT

1 From front side of frame, insert fabric graphic into all 4 corners first, in diagonal order.

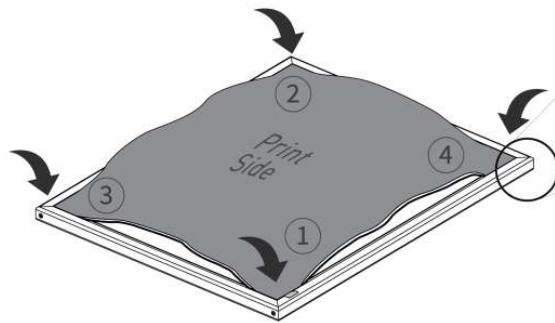

TIP Be sure printed side is facing out and the silicon edge is oriented as shown here.

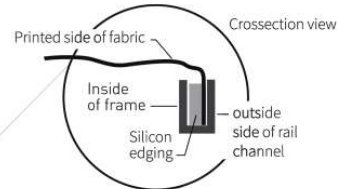

2 Insert fabric edge only at the center of each channel, pushing directly downward.

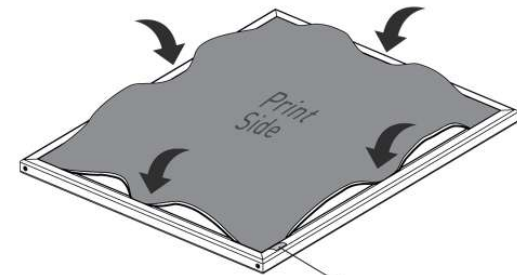

Pull-tab for removing fabric graphic, is sewn into edge and can also be tucked away.

3 Use downward pressure to insert the remaining edge, working out from the center toward each end.

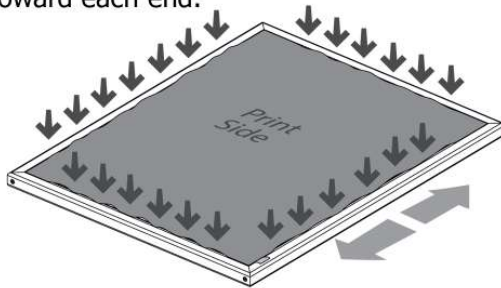

4 Complete.

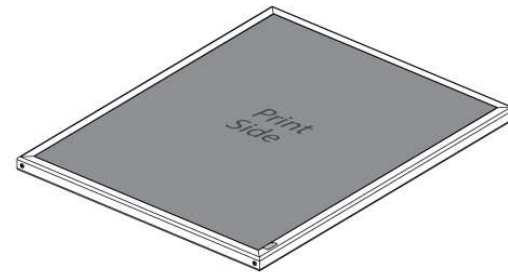

Q Are iMPAKT lightboxes back-lit or side-lit

iMPAKT boxes can be either back-lit or side-lit depending on your needs.

Q What is the difference between back-lit and side-lit

Back-lit lightboxes have a higher brightness and a higher price point. They also consume more electricity and weigh more. Side-lit lightboxes give you the choice of using no backer making shipping easy, and the lightbox itself less expensive.

Q Can I mount the lightbox on a wall? How?

Yes, with wall mounting brackets or directly through extrusion lip (see 06 Mounting on a Wall).

Q What sizes are available?

Back-lit max height is 15.5ft without seaming the print. Side-lit max height is 12ft without losing brightness in middle.

Q What info do I need to pass on to my installers regarding electrical?

99% of situations are plug and play. The other 1% is a standard/simple electrical connection which we will provide an instruction video and/or manual for.